

49

130
SCHNETLER'S
P O BOX 36893 CHEMPET 7441

VIR ENDOSSEMENTE KYK BLADSY
FOR ENDORSEMENTS SEE PAGE

PREPARED BY ME,

CONVEYANCER
B L I'ONS

SEELPES DUTY	R. /
FOOI FEE	R. 9500

Erf 30052 = 104 m²

GETRANSPORTEER AAN	TRANSFERRED TO
FE Smith	
RESTANT/REMAINDER	4,5978 m ²
③ T 017206 * 2001	
2001-03-16	REGISTRATEUR/REGISTRAR

T 017204 * 2001

REKENAAR: DATAVASLEGGING/COMPUTER DATA CAPTURE		
OPERATOR	DATE	OPERATOR
	27/3	
IS TRAP VERIFIED		

DEED OF TRANSFER

(By virtue of Section Thirty One of the Deeds Registries Act, 1937 (No. 47 of 1937))

BE IT HEREBY KNOWN :

That whereas the undermentioned land has been vested in the CITY OF CAPE TOWN by virtue of Section 28 of Land Use Planning Ordinance 15 of 1985 which land is at present registered in the Deeds Registry at Cape Town in the name of

THE MILNERTON ESTATES LIMITED
Company No. 1897/000196/06

under Certificate of Registered Title No. T 25627/1984

ll

4/

Endorsement

By virtue of Notarial Agreement No
K 000000387/2016, dated 14th June 2016, the
within mentioned property has been declared a
Nature Reserve in terms of section 23(3) of The
National Environment Management: Protected
Areas Act No 57/2003, with ancillary rights.

As will more fully appear from said Notarial
Deed.

Deeds Registry

Cape Town

08 MAY 2018

Registrar of Deeds



And whereas a Certificate has been furnished to me in terms of Section Thirty One (4)(a) of Act 47 of 1937 by the Transferee to the effect that the provisions of any law in connection with the change of ownership in the land in consequence of the vesting have been complied with.

Now therefore, by virtue of the authority vested in me by the said Act, I, the Registrar of Deeds at Cape Town do, by these presents, cede and transfer in full and free property to and in favour of

CITY OF CAPE TOWN

its successors in title or assigns

ERF 11051 MILNERTON (PUBLIC PLACE)

IN THE CITY OF CAPE TOWN

CAPE DIVISION, PROVINCE OF THE WESTERN CAPE;

IN EXTENT: 4,6082 (FOUR comma SIX ZERO EIGHT TWO) Hectares;

AS WILL APPEAR from Diagram S.G. No. 3736/1999 and held by Certificate of Registered Title No. T 25627/1984;

SUBJECT to such conditions referred to in Deed of Transfer No. T 11382/1960.

}

W.

Wherefore the said **THE MILNERTON ESTATES LIMITED** is entirely dispossessed of and disentitled to the said land, and that by virtue of these presents the said **CITY OF CAPE TOWN**, its successors in title or assigns now is and hereafter shall be entitled thereto, conformably to local custom, the State, however, reserving its rights.

In witness whereof I, the said Registrar, have subscribed to these presents, and have caused the seal of office to be affixed thereto.

THUS DONE AND EXECUTED at the Office of the Registrar of Deeds, at CAPE TOWN on 16 March

2001



REGISTRAR OF DEEDS

14.

ACCOUNT NO. CTN 130
 SCHNETLER'S
 TEL: 52 4844

130

TP
 GENERAL PLAN 10541

DE VILLIERS REID CHIDDY & MURRAY
 Professional Land Surveyors

SIDES Metres	ANGLES OF DIRECTION
AB 87,23	270 53 40
BC 36,00	180 53 40
CD 10,00	224 19 00
DE 37,50	314 19 00
EF 91,27	224 19 00
FG 109,01	279 10 30
GH 58,44	219 42 10
HJ 12,00	309 42 10
JK 32,00	39 42 10
KL 220,00	309 42 10
LM 26,00	219 42 10
MN 4,00	309 42 10
NP 6,00	219 42 10
PQ 10,00	309 42 10
QR 13,00	4 54 40
RS 32,37	274 54 40
ST 53,20	219 42 10
TU 80,41	309 42 10
UV 14,72	4 54 40
VW 588,14	94 54 40
WA 71,05	123 23 40

S. G. No.
 3736/1999
 Approved
Alfred
 Surveyor-General
 2-8-1999
 SHEET 1 of
 2 SHEETS

BEACONS:

All - 12mm round iron pegs

The figure A B C D E F G H J K L M N P Q R S T U V W
 represents ~~4,0908~~^{4,6082} hectares of land, being

ERF 11051 MILNERTON (Public Place)

situate in TABLE VIEW TOWNSHIP Ext.No.13
 in the BLAAUWBERG MUNICIPALITY
 Administrative District of the Cape Province of the Western Cape
 Surveyed in March to October 1983
 by us *P. Chiddy* P.Chiddy PLS-0091 *T.J. Chiddy* T.J.Chiddy PLS-0092
 Professional Land Surveyors

This diagram is annexed to DEED OF TRANSFER No. 017204 * 2001 dated 2001-09-18 i.f.o. BLAAUWBERG M.M. Registrar of Deeds	The original diagram is No. _____ annexed to Transfer/Grant No. _____	File No. S 13270/6 S.R.No. E 2383/1983 Comp. BHSS-2343 (M1384) BHSS-2341(M1378) BHSS-1464(922) BHSS-1462(930) Gen. Plan No. 10541
	(M1548)	

DE VILLIERS REID CHIDDY & MURRAY
Professional Land Surveyors

ERF 11051 MILNERTON (Public Place)

S.G. No.

3736/1999

Approved

Allochyan

Surveyor-General
2-8-1999

SHEET 2 of
2 SHEETS

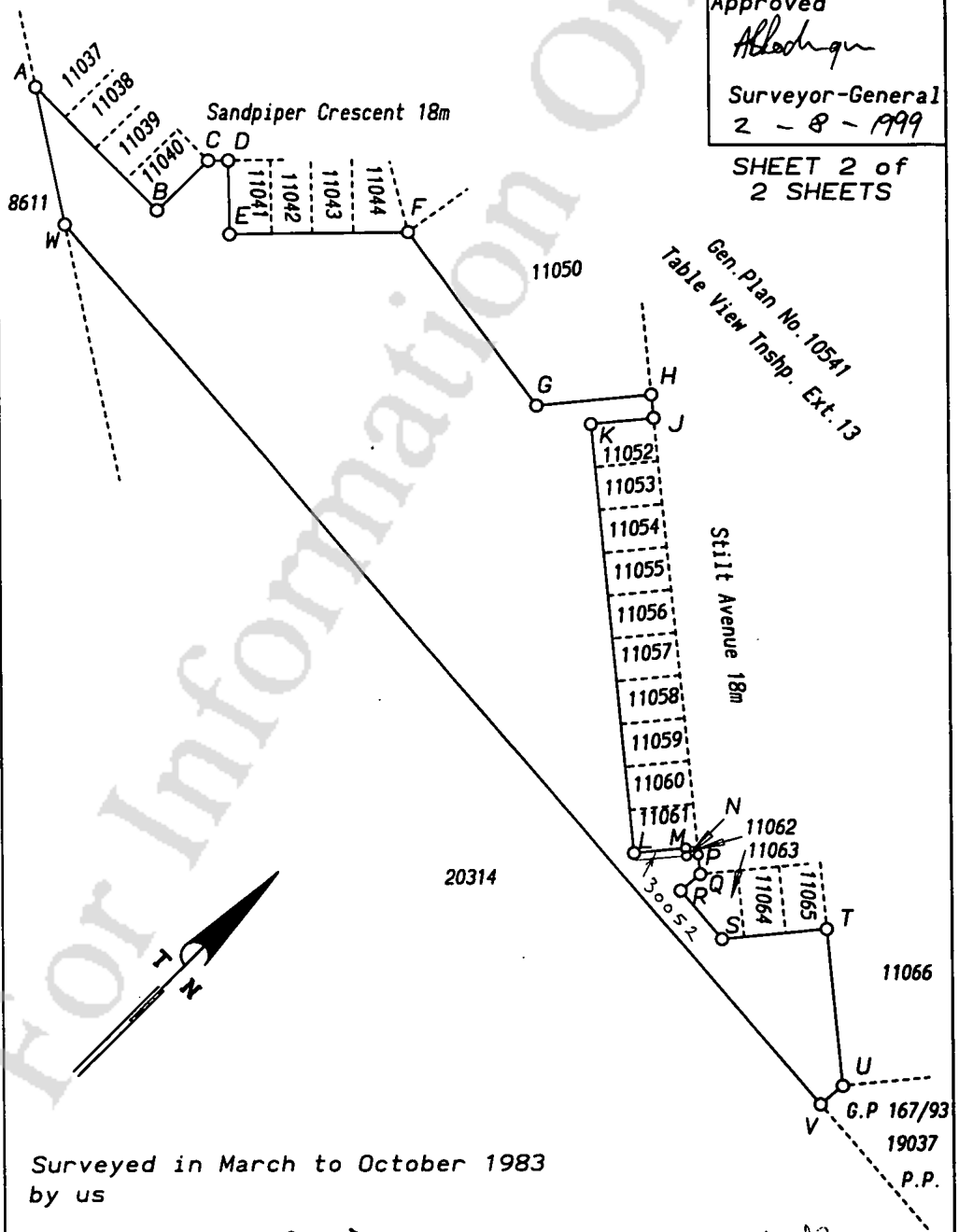

Gen. Plan No. 10541
Table View Trshp. Ext. 13

Stillt Avenue 18m

Public Plans
 Plans registered with the Surveyor-General
 ERF 30052
 Classif. Noting d.d. 1999-07-02
 File No. 13270/6
 135
 2-8-1999
 S.G. No.
 Surveyor-General

Surveyed in March to October 1983
by us

P. Chiddy

T. Chiddy

P. Chiddy PLS-0091

T. J. Chiddy PLS-0092

Professional Land Surveyors

Scale: 1/3000

SECRET

SECRET

For Information Only

...
...
E1569/99	3737/999	EA	30052				

SECRET